

ENDOSCOPIC LINEAR CUTTING STAPLERS

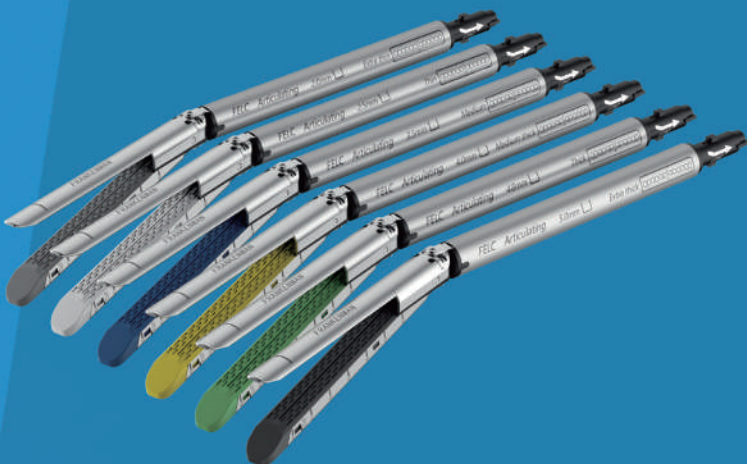

 **FRANKENMAN**



WHEN YOU PUT PATIENTS' HEALTH FIRST,
REMARKABLE THINGS HAPPEN

The Frankenman FELC Series has a reversed cartridge design, easy for ligation and dissection in narrow space, stronger cutting force, great reliability and unique anvil production technique, greater integrity allow stronger compression force for thicker tissue.

THE FEATURES

- Reversed anvil
- Integrated knife with self lubrication design
- Widened ergonomic firing handle
- Innovative anvil production technique
- New design to achieve 45 degrees rotation with 3 level on both right & left side

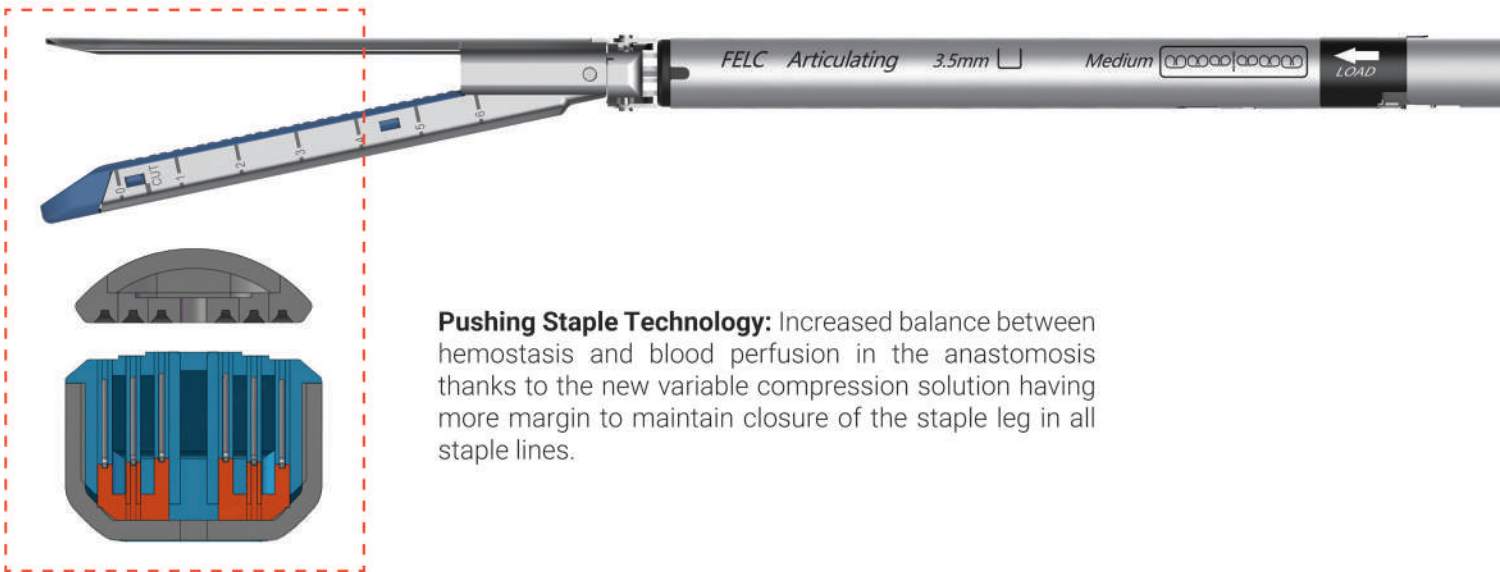

Pushing Staple Technology: Increased balance between hemostasis and blood perfusion in the anastomosis thanks to the new variable compression solution having more margin to maintain closure of the staple leg in all staple lines.

Different height pushers make a different staple forming height, to get a strong anastomosis.

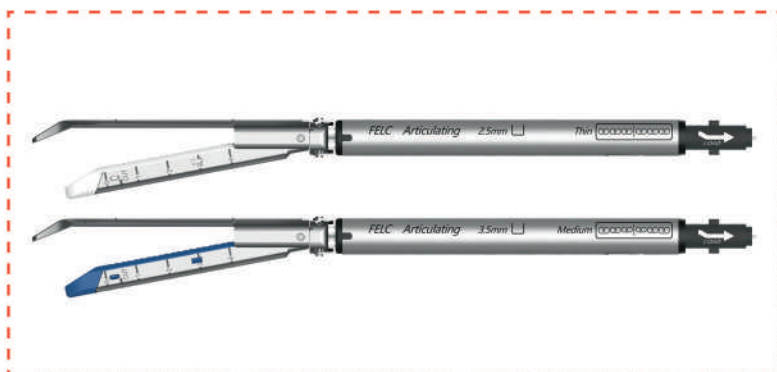
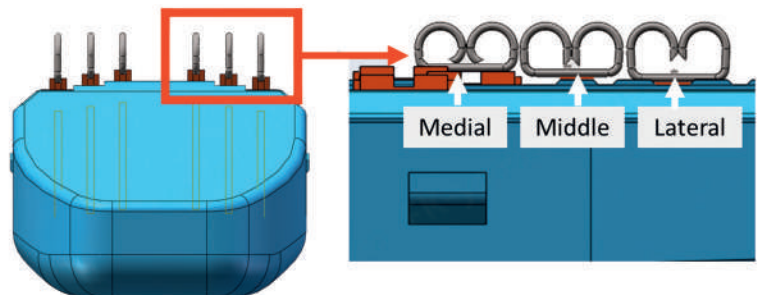

Articulated Curved Tip reloads: designed for enhanced visibility and ease of use for fine dissection and transection in limited spaces around target tissues and vessels



THE BENEFITS

- Easy access to ligate and compress tissue & vessel in narrow space
- Higher cutting strength and improved reliability; firing force is significantly reduced
- Easier and convenient device firing
- Robust anvil with stronger compression for the same tissue thickness
- Easier ligation and anastomosis of tissue in narrow space

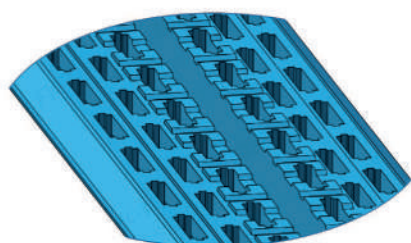

Wavy Grip Solution: The wavy surface of the reload holds the tissue firmly in place, preventing the slippage during the cutting process and retraction of the blade.

Triple-tiered reload surface: 0,15mm step difference design. The double-sided slanted structure makes the tissue slide on both sides after being compressed for better thickness and proper staple forming.

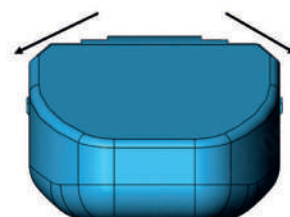

Product Code	Shaft Length (mm)	Working length max (mm)	EXTERNAL DIAMETER (mm)	UNITS PER BOX
FELC50	60	280	12.5	3
FELC150	160	380	12.5	3
FELC250	260	480	12.5	3

Model	Colour	Reloading Unit Type	Staple Line Length L2/mm	Open Staple Height H/mm	Closed Staple Height H/mm		Degree of Articulation W/°	Staple Quantity	Staple Crown (mm)	Units per Box	
NER30-2.0	●	Reversed Stepped Reloading unit	32	2.0	0.75	0.75	45	48	3	6	
NER30-2.5	○			2.5	1.00	1.00		48	3	6	
NER30-3.5	●			3.5	1.35	1.50		48	3	6	
NER30-4.0	●			4.0	1.60	1.75		48	3	6	
NER45-2.0	●		44	2.0	0.75	0.75		0.75	66	3	6
NER45-2.5	○			2.5	1.00	1.00		1.00	66	3	6
NER45-3.5	●			3.5	1.35	1.50		1.65	66	3	6
NER45-4.0	●			4.0	1.60	1.75		1.90	66	3	6
NER45-4.8	●		60	4.8	1.85	2.00		2.15	66	3	6
NER60-2.0	●			2.0	0.75	0.75		0.75	90	3	6
NER60-2.5	○			2.5	1.00	1.00		1.00	90	3	6
NER60-3.5	●			3.5	1.35	1.50		1.65	90	3	6
NER60-4.0	●	60	4.0	1.60	1.75	1.90	90	3	6		
NER60-4.8	●		4.8	1.85	2.00	2.15	90	3	6		
NEPR30-2.0	●		32	2.0	0.75	0.75	0.75	48	3	6	
NEPR30-2.5	○			2.5	1.00	1.00	1.00	48	3	6	
NEPR30-3.5	●	3.5		1.35	1.50	1.65	48	3	6		
NEPR30-4.0	●	4.0		1.60	1.75	1.90	48	3	6		
NEPR45-2.0	●	Reversed Reloading unit with Curved Tip	44	2.0	0.75	0.75	0.75	66	3	6	
NEPR45-2.5	○			2.5	1.00	1.00	1.00	66	3	6	
NEPR45-3.5	●			3.5	1.35	1.50	1.65	66	3	6	
NEPR45-4.0	●			4.0	1.60	1.75	1.90	66	3	6	
NEPR45-4.8	●	44	4.8	1.85	2.00	2.15	66	3	6		



The Frankenman Academy is proud to promote several training courses in numerous surgical disciplines with expert faculty to cover both didactic elements and "hands on" skills workshops.

QUALITY CONTROL

We pride ourselves on world leading continual quality improvement processes.

ALL stapling devices and reloads have a unique serial number, as well a batch/lot number, to allow for more accurate tracking and traceability.

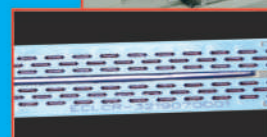

www.frankenman.com | info@frankenman.co.uk | +86-512-68786150

Frankenman International Ltd - 108 Jinfeng South Road, High New District, - Suzhou, 215163, P.R. China

FELC02/2024A